

GB703

INSTALLATION TOOL SERIES

GB703

Stroke - .780" (19.8 mm)
 Hand held weight - 4.50 lbs (2 kg)
 Entire tool weight - 4.50 lbs (2kg)
 Pull load - 2,200 (9.8 kN)

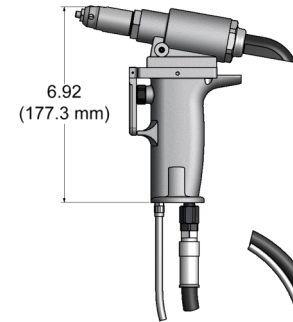
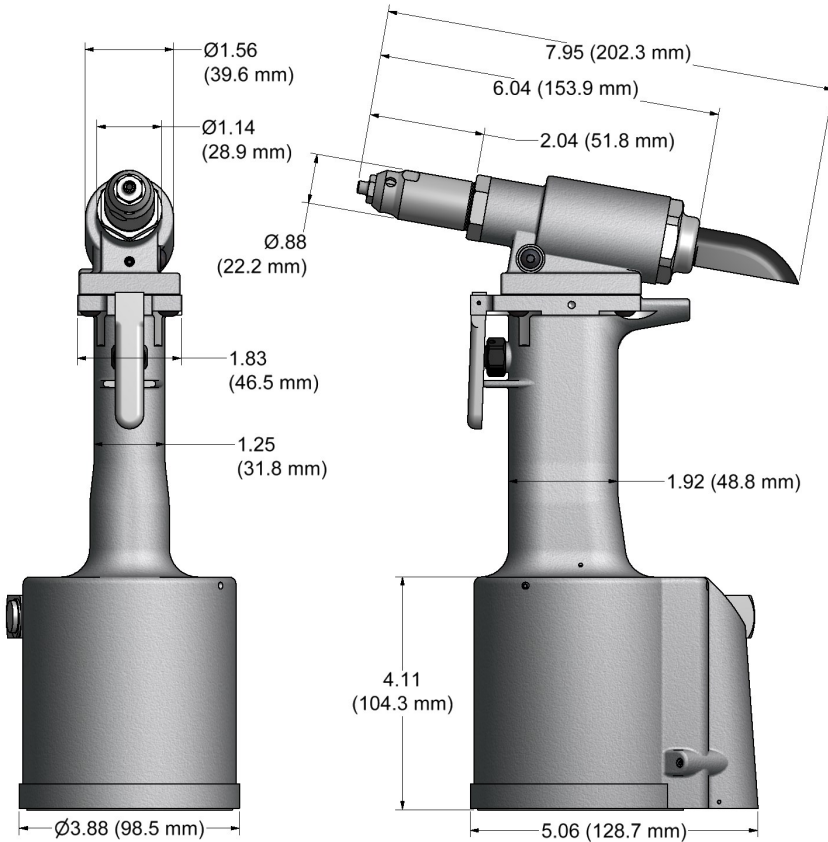

GB703SH

Stroke - .780" (19.8 mm)
 Hand held weight - 2.00 lbs (.9 kg)
 Entire tool weight - 7.25 lbs (3.3 kg)
 Pull load - 2,200 (9.8 kN)

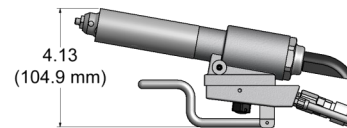

GB703SR

Stroke - .780" (19.8 mm)
 Hand held weight - 1.50 lbs (.7 kg)
 Entire tool weight - 4.50 lbs (2 kg)
 Pull load - 2,200 (9.8 kN)



*For pintail collection bottle and pintail evacuation tube options, see back.

DESCRIPTION

The GB703 series are pneumatic-hydraulic tools designed specifically for the efficient installation of a wide range of blind rivets. They can be operated in any position with one hand. They have a rated pull load of 2,200 pounds (9.8 kN) with 90 psi (6.2 bar) of air pressure at the air inlet.

The GB703SH and GB703SR riveters offer a unique "split" system providing the operator with an ergonomic tool with reduced hand held weight, as shown below. The GB703SH comes with 8 feet of hose and the GB703SR comes with 3 feet of hose.

The GB703 series riveters operate on 90 to 100 psi (6.2-6.9 bar) of air pressure, with 90 psi (6.2 bar) providing the maximum efficiency. At 90 psi (6.2 bar) air pressure, the GB703 series does not exceed 85 dB(A) and consumes 3 cfm at 20 cycles a minute.



GB703-NOSE ASSEMBLY SELECTION CHART & ACCESSORIES



ACCESSORIES (SOLD SEPARATELY)

Air Bleeder Assy
#704153
(Equivalent to #700A77)



Catcher Bag
#704214
(Equivalent to #670A20)



Extensions

These extensions help reach many restricted areas by increasing the overall length of the nose assembly. They fit directly on the GB703 Installation Tool.

L	Part Number	Equivalent to:
2"	703002	743A50
4"	703004	-
6"	703006	-

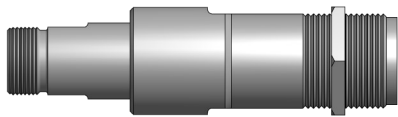

Unless ordered rivet specific (I.E. GB703/4N), the GB703 series riveters are furnished with nose assembly 6N-703-18 and spare nose tip 10202 and follower 40307 to convert to 4N-703-18 nose assembly. All other nose tips must be ordered separately. When ordering tool rivet specific, contact Gage Bilt for more information.

"VT" riveters are not furnished with the nose assemblies above and must be ordered for your specific rivet.

OPTIONS

The GB703 series riveters may be ordered with a vacuum system. Gage Bilt offers two varieties (see below).

Order GB703 series riveters rivet specific by adding the appropriate suffix (see selection chart).

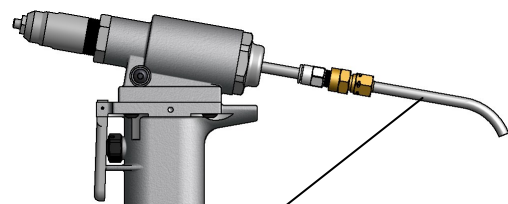

"VT" DESIGNATION = PINTAIL EVACUATION TUBE
(TOOL MUST BE ORDERED FOR YOUR SPECIFIC RIVET. CONTACT GAGE BILT INC. FOR SPECIFIC APPLICATIONS.)

NOSE ASSEMBLY CHART (For Non-Vacuum Tools Only) (SOLD SEPARATELY)

RIVET	DIA.	NOSE ASSEMBLY	NOSE TIP 1	JAW	FOLLOWER
AVEX® (1624 PROTRUDING HEAD)	3/16	AV6-703-18 1	10141	30617	40605
AVEX (1624 COUNTERSUNK HEAD)	3/16	6C-703-18 1	10141-1	30617	40605
KLAMP-TITE® (STRUCTURAL) RIVET	3/16	6KT-703-18 1	10263	30617	40605
	1/4	8KT-743-24 2	-	-	-
MACHINE SCREW RIVET	5MM	MS5M-703-18 1	10332	30617	40605
NAS1719, NAS1720, NAS1721 MBC®	1/8	MBC04-703-18 1	10251	30617	40307
	5/32	MBC05-703-18 1	10252	30617	40605
	3/16	MBC06-703-18 1	10253	30617	40605
MILLIMETER SEAL PLUG	4MM	5N-703-18 1	10203	30617	40605
	5MM	6N-703-18 1	10204	30617	40605
MONOBOLT® RIVET	3/16	MB06-734A-20 2,5	-	-	-
	1/4 3	MB08-734A-20 2,5	-	-	-
NUTFLATE RIVET CCR244/264/274 BACR15DR MS20600	3/32	3NP-703-18 1	10231	30617	40307
	1/8	5N-703-18 1	10203	30617	40605
POP® OPEN END NAIL RIVET	3/32	3N-703-18 1	10201	30617	40307
	1/8	4N-703-18 1	10202	30617	40307
	5/32	5N-703-18 1	10203	30617	40605
	3/16	6N-703-18 1	10204	30617	40605
	1/4 3	8N-743-24 2	-	-	-
POP® CLOSED END NAIL RIVET (ALUMINUM MANDREL)	3/32	3N-703-18 1	10201	30617	40307
	1/8	4CEA-703-18 1	13471	30617	40307
	5/32	5CEA-703-18 1	13472	30617	40605
	3/16	6CEA-703-18 1	13473	30617	40605
POP® CLOSED END NAIL RIVET (STEEL MANDREL)	3/32	3N-703-18 1	10201	30617	40307
	1/8	4CES-703-18 1	13475	30617	40307
	5/32	5CES-703-18 1	13476	30617	40605
	3/16	6CES-703-18 1	13477	30617	40605
PLASTIC SPLIT RIVET	1/4 3	8CES-743-24 2	-	-	-
	3/32	3P-703-18 1	10247-1	30617	40307
	1/8	4P-703-18 1	10202-4	30617	40307
	5/32	5P-703-18 1	10203-2	30617	40605
SCREW RIVET	3/16	6P-703-18 1	10167	30617	40605
	1/4	8P-743-24 2	-	-	-
T RIVET®	3/16	6SR-703-18 1	13506	30617	40605
TLR® RIVET	1/4 3	8T-743-24 2	-	-	-
	1/4	8TLR-743-24 2	-	-	-
COUNTERSUNK HEAD MAGNA-LOK® & SERRATED STEM STRUCTURAL RIVETS	3/16	C6-734A-20 2,5	-	-	-
PROTRUDING HEAD MAGNA-LOK® & SERRATED STEM STRUCTURAL RIVETS	1/4 4	C8-734A-20 2,5	-	-	-
	3/16	PH6-734A-20 2,5	-	-	-
	1/4 4	PH8-734A-20 2,3,5	-	-	-

AVEX®, KLAMP-TITE®, TLR®, AND MONOBOLT® ARE REGISTERED TRADEMARKS OF AVDEL UK LIMITED. T RIVET® AND MBC® ARE REGISTERED TRADEMARKS OF AEROSPACE FASTENERS. POP® IS A REGISTERED TRADEMARK OF EM HART TECHNOLOGIES. MAGNA-LOK® IS A REGISTERED TRADEMARK OF ARCC

1) YOU CAN CHANGE THE 703-18 NOSE ASSEMBLY (INCLUDED WITH TOOL) TO INSTALL OTHER FASTENERS BY P NOSE TIP SHOWN AND USING APPROPRIATE FOLLOWER SHOWN.

2) NOSE ASSEMBLIES WITH A 743-24 AND 734A-20 DESIGNATION, I.E. 8N-743-24, MUST BE ORDERED AS COMPLETE N

3) ALUMINUM RIVET STEEL MANDREL ONLY (100 PSI REQUIRED FOR ALL 1/4" STEEL RIVETS).

4) 1/4" ALUMINUM ONLY.

5) NOSE ASSEMBLIES WITH A 734A DESIGNATION, I.E. PH-6-734A-20, ARE FOR SERRATED STEM RIVETS ONLY. IF YOL

HOW TO ORDER GB703 SERIES TOOLS

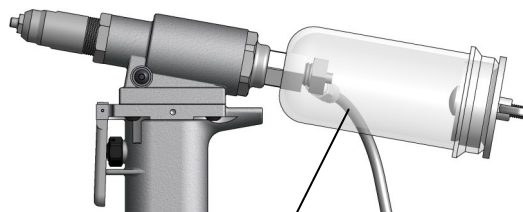
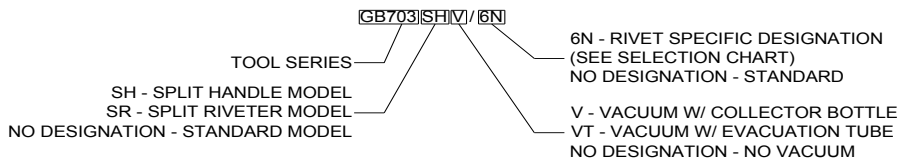

"V" DESIGNATION = PINTAIL COLLECTION BOTTLE