

840204 ADAPTER DATA SHEET

To attach adapter and nose to tool:

1. Place adapter nut (3) into threaded end of collet with thread forward as shown. Thread collet adapter (2) onto head piston.
3. With collet placed in nose assembly anvil, tighten both onto anvil adapter assembly (1).
4. Slide anvil adapter (1) over collet adapter (2) and lock into place on tool. Slide drawbar into nose assembly thru adapter assembly.
5. Using tee-wrench (4) thru rear of installation tool and 1/4" allen wrench on front of nose assembly drawbar tighten nut to drawbar.

CAUTION

Pintail may eject forcibly.
Used for closed access applications only to prevent severe personal injury!

To remove adapter and nose from tool
reverse assembly instructions

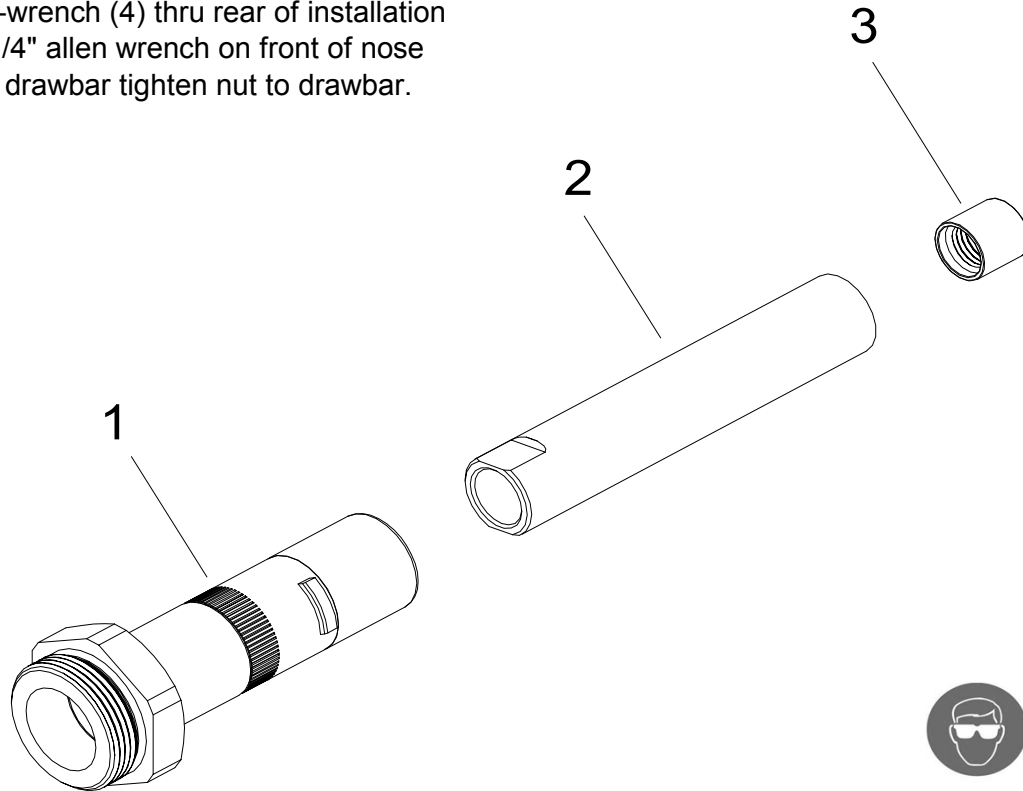

7/08

GAGE BILT

GAGE BILT Inc.

44766 Centre Court (586) 226-1500
Clinton Twp. MI 48038 (586) 226-1505 Fax
e-mail:solutions@gagebilt.com / www.gagebilt.com

Type:	Adapts GB204A Series Nose Assemblies to: G83 and G84 tools
Rotatable Offset Nose Assembly Adapter	

Ref. No.	Qty.	Description	840204
1	1	Anvil Adapter Assembly	352209
2	1	Collet Adapter	352210
3	1	Nut	352211
4	1	Tee-Wrench	A-291